

AIR OPERATED DIAPHRAGM PUMPS

DF30 NON METALLIC PUMPS WITH DUAL INLET

553 020

Dual inlet pumps for 1:1 proportion mixing of fluids with similar viscosity. Both fluids and the resulting solution must be compatible with the pump wetted materials.

38 l/min (10.4 US gpm), 2 x 3/8" fluid inlet and 1/2" fluid outlet.

MODELS AND APPLICATIONS

APPLICATION	WETTED MATERIAL	CHECK BALLS	DIAPHRAGMS	PART No.
1:1 SOLUTIONS OF WATER, ANTIFREEZE AND WATER, WINDSHIELD WASH	Polypropylene	PTFE	Hytre®	553 020

TECHNICAL DATA

Pressure ratio	1:1
Maximum free delivery (1)	38 l/min (10.4 US gpm)
Delivery per stroke (1)	0,07 litres (0.019 US gallons)
Air pressure operating range	3 to 7 bar (45 to 100 psi)
Solids in suspension max size	3 mm (1/8")
Max dry suction head (1)	2,5 m (8.2')
Max wet suction head (1)	8 m (26.25')
Weight	2,2 Kg (4.85 lb)
Fluid inlet	2 x 3/8" BSP/NPT (F)
Fluid outlet	1/2" BSP/NPT (F) and flange
Air inlet	3/8" NPSM (F)
Wetted part materials	See models and applications

(1) Data measured with water, air inlet pressure 7 bar, 20 °C.

DIMENSIONS (mm)

A	B	C	D	E	F	G	I
130	160	162	105	122	8	140	70
J	K	L	M				
1/2" (F)	145	3/8" (F)	24				

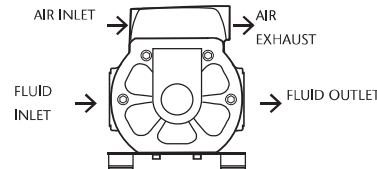
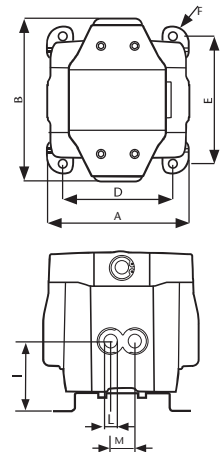

CAPACITY

Tested at room temperature, with water and flooded pump with 80 mm (3.5 inches) positive suction.

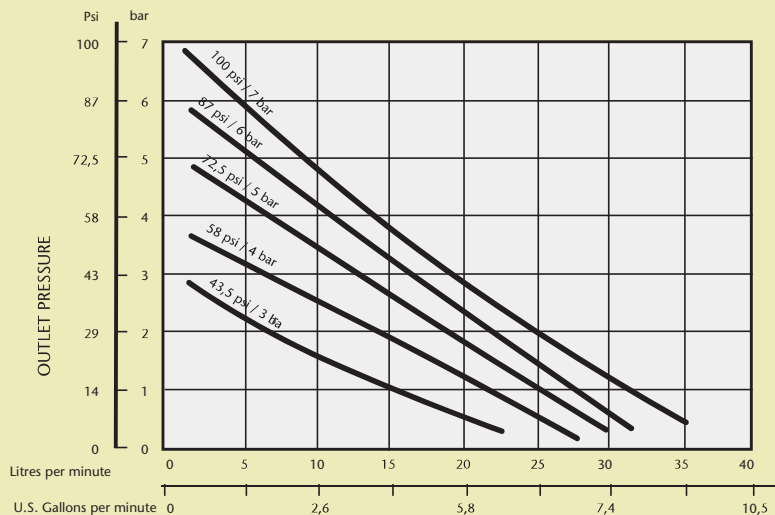

AIR CONSUMPTION

100 psi/7 bar SCFM-NL/min	87 psi / 6 bar SCFM-NL/min	72,5 psi / 5 bar SCFM-NL/min	58 psi / 4 bar SCFM-NL/min	43,5 psi / 3 bar SCFM-NL/min
0	0	0	0	0
2.01	59.3	0	0	0
2.21	65.3	0	0	0
2.51	73.9	0.67	19.8	72,5 psi / 5 bar SCFM-NL/min
2.89	85.3	1.72	50.8	0
3.37	99.4	2.67	78.9	0.87
3.94	116.2	3.53	104.1	1.94
4.61	135.8	4.28	126.3	2.89
5.36	158.2	4.94	145.6	3.74
6.21	183.2	5.49	162	4.49
7.16	211.1	5.95	175.5	5.12
8.19	241.6	6.31	186.1	5.65
9.32	274.9	6.57	193.7	6.07
10.54	310.9	6.73	198.4	6.38
11.85	349.7	6.79	200.3	6.59
			194.3	5.33
			157.3	3.9
			115	